



Chelsea Barracks

LONDON | 2014-

Gustafson Porter + Bowman have led the concept landscape design and development of all six phases of the Chelsea Barracks development since 2014 alongside a large number of consultants and architects including, Eric Parry Architects, PDP London and Squire and Partners.

Chelsea Barracks creates a sequence of permeable public spaces which sensitively respond to the historic context of the area whilst providing a contemporary scheme that is accessible, permeable and embraces a continuous identity. Across all phases, the choice of materials and planting unifies the public realm, while the design and detailing of each space creates individual characters.

To define the relationship between the architecture and external spaces within the development, reference is made to the surrounding urban character of Chelsea. This includes the red-brick buildings of the Cadogan Estate, parts of the Grosvenor Estate which sit adjacent to the site, and Pimlico, one of the oldest villages in Chelsea.

Our design creates a typology of open spaces that invite people in to enjoy the new addition to the neighbourhood and the natural environment. We have sought to move away from the traditional masterplan concept (typically characterised by garden squares with railings), reversing an eighteenth-century element of social interventionism.

The development is therefore, a space for communal integration and spontaneous interaction which embodies timeless qualities using thoughtful planting, high-quality materials and urban furniture. The squares throughout the scheme evoke a purposeful character while providing a varied and engaging environment.

The first four phases continue to establish as the community builds around its gardens, and the new garden squares provide coherent and integrated, yet diverse palettes and moods throughout the Barracks.

SCOPE	Landscape design for public and private areas of masterplan
BUDGET PROJECT COST	Confidential
CLIENT	Qatari Diar
PROJECT DURATION	2014-
SIZE	1ha
STATUS	Phases 1-4 completed

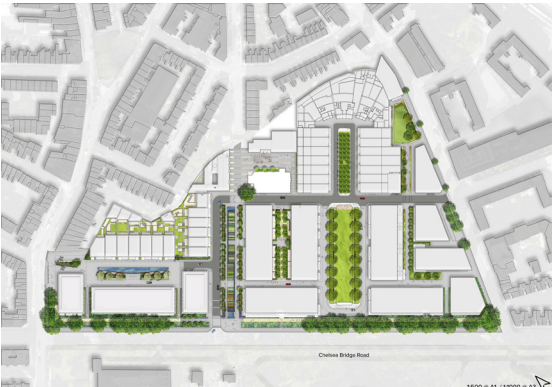



Mulberry Square (above and left) is a contemporary, culinary garden, and the centrepiece and main entrance to Chelsea Barracks. Lined by rows of fruiting trees, the garden is framed by a strong evergreen structure. At its heart, the colourful planted bands change throughout the season as a kinetic wave inspired by the work of Bridget Riley. Water channels that weave through these planters, culminate in a raised table facing the Royal Hospital.

Bourne Walk (above) is a continuous ecological corridor the length of Chelsea Bridge Road. Conceived as an elegant walk framed by native hedgerows and biodiverse planting, the natural character enhances the original railings and London Plane trees of the Barracks. The continuous movement of water along the rill guides the visitor on their walk and planting provides a landscape for larger species of birds and wildlife.



Dove Place (above) marks the entrance to the site from Pimlico, framed by bronze and granite planters. 'Bicameral' by Conrad Shawcross sits within the largest planter, surrounded by low, evergreen planting. Conceived as an open woodland, character is refined and understated, coming to life in early spring, with white, yellow, and blue flowering woodland bulbs.

Whistler Square (above) inverts the traditional London square, bringing visitors through the heart of the space. An 80m-long scrim, built out of Cumbrian slate and with a pattern that evokes the history of the Thames, brings the sound of moving water to the landscape, animating the space and providing a sense of calm.